

## Lamp Replacement Procedure

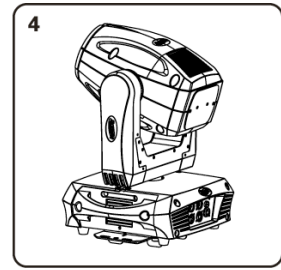
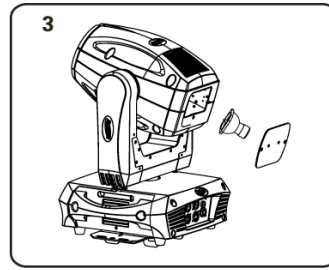
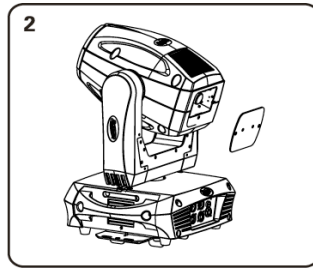
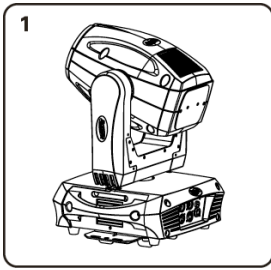

1. Set the fixture on a flat surface and remove the two screws on the back of the moving head marked "A" and "B"
2. Remove the cover plate to access the lamp
3. Gently remove the old lamp by grasping the ceramic socket base and twisting it slightly in counter-clockwise direction until it becomes free
4. Once the lamp becomes free, grasp the ceramic socket and gently pull away from the lamp
5. Remove the 2 cable leads from the lamp by gently wiggling them left and right. **(Be sure not to wiggle the leads up and down as they are more susceptible to breaking)**
6. Reconnect the 2 leads to the new lamp, ensuring they snap on completely
7. Insert the new lamp. The lamp will only seat one way, please be sure to insert the lamp in the same position as the old one. Before reassembling the unit, be sure the new lamp is securely seated in the lamp socket. Always be sure to only use specified lamp types. (Philips MSD Platinum 5R).
8. Once the lamp has been inserted and secured into the socket, lock the lamp cover back in to place by securing screws "A" and "B"
9. Next, the lamp hours need to be reset within the system menu. Activate the menu by pressing the "Mode/Esc" button and toggle to "Information"
10. Once at "Information" tap the "Enter" button and use the "Up" or "Down" buttons to toggle to "Time Information"
11. Once at "Time Information" use either the "Up" or "Down" buttons to toggle to "L-Timer Password" and tap the "Enter" button. Then use the "Up" or "Down" buttons to enter the reset pass code, "038" and tap the "Enter" button once again. The display will automatically revert to "L-Timer Password," next toggle down to "Clear Lamp Time"
12. Once at "Clear Lamp Time" tap the enter button and select "ON." The lamp timer has now been reset, use the "MODE/ESC" button to exit the menu and return to the home screen.